

## Newsletter launches

**Welcome** to this first edition of *The Allotment* our new newsletter which it is hoped will become a regular feature of the Allotment Year! The intention is that it will provide a more dynamic way of communicating between the Allotment Tenants and the Parish Council than the more traditional emails and letters etc. and have growing tips and ideas.

We want to encourage contributions so do please feel free to let us have your drafts and suggestions for pages and articles – please initially use the contacts form on the parish website – [yetminsterparishes@gov.uk](mailto:yetminsterparishes@gov.uk) but we hope to set up our own “The Allotment ” email address in the future.

The Editor



***The Hamcrate Allotments—all very tidy and organised at the start of the season!***

## Parish Council and Allotment Reps to Meet

The Big News is that The Parish Council and the nominated Hamcrate Reps are getting together with advisors from the National Allotment Society to look at the options for forming an Allotment Association. This is seen as a way of giving the Allotment Tenants a voice and something that the council have been keen to encourage for a number of years. It is however recognised that not all those with allotments will want to join or be involved with an association and there is no intention to make membership compulsory or to make decisions without consultation. Background and more information inside!

### What's Inside?

**Page 1** Welcome and “Big News”

**Page 2** What's Been Going On - Background to meeting of Allotment Users and progress

**Page 3** November Planting Tips and map explanation

**Page 4** Notes from the Parish Council - Allotment Car Park, SOS idea

**Flyer** Allotment Reps update and Statement of Agreement



# THE ALLOTMENT



## So What's been going on?

A meeting of the Hamcrate Allotment Tenants was held to discuss the issues and to decide upon a way forward further to the Yetminster Parish Council meeting in June 2023, where issues concerning the allotments were raised and it was agreed that a meeting between the Council and its Allotment Tenants be beneficial. The meeting was well attended by twenty-two allotment users from seventeen plots and the discussions covered many issues including the formation an Allotment Association (as encouraged by the Council), the proposed removal of the hedge between the Sports Club car park and allotments, fencing to prevent the access of deer, other animals and unauthorised persons, the provision of additional water points, waiting list prioritisation, grass cutting and grounds maintenance, composting and waste disposal. It was agreed that there should be one or more nominated tenants who would represent the group at the proposed forthcoming meeting with the Parish Council and the elected representatives are Rod Dinnage, Mike and Cynthia Bees, Mike Bird, Douglas Carswell and Peter Mason.

Rod Dinnage has been working with David Torrance from the Council to draw up a "Statement of Agreement" the intention of which is to acknowledge that there are common areas of agreement between both parties and hopefully create a non threatening basis for future discussions. This has been agreed by the Allotment Representatives and approved and adopted at the meeting of the Parish Council in September.

It was also agreed that this statement should be sent to all the Allotment Tenants and it is attached as a flyer to this newsletter together with a copy of the Allotment Representative's update as circulated to those who attended the initial meeting.

As mentioned in "Big News" a meeting has been arranged to discuss the potential of setting up an Allotment Association and Rod and David are now working on the Agenda for this. Once the various options are understood, together with the pros and cons, then a report will be circulated with recommendations and the views of everyone will be sought.

RD & DIT



The Parish Council is a member of the National Society of Allotment and Leisure Gardeners but what is it? It is the national representative body for the allotment movement in the U.K. They are governed by volunteers from their regional bodies in England and Wales (the Regional representatives) and their membership is made up of allotments associations, societies and federations, schools, councils, landlords and individuals; although the majority of members join through their individual allotment association.

Through the membership they serve over 125,000 "allotmenters", assisting them to acquire, maintain, manage and enjoy allotments across the country.

# THE ALLOTMENT

## What to do in November— advice from the man with the spade



Dig, Dig, Dig!



Collect up weeds



Make good and secure for the winter months

Autumn is underway now, with early evenings and colder days but there is still plenty to grow for over wintering to help reduce the workload for next spring when it is a busy time. It also occupies otherwise empty soil beds. There is a range of vegetables and dormant fruit trees you can plant now if the soil is not frozen.

Cleared soil beds will benefit from digging over and some well-rotted manure or organic matter mixed in. This will help make for a healthy soil bed next year when the season starts again. Frosts throughout winter will help break down the clumps of soil.

Planting Ideas— Broad beans , Onions, Shallots, Garlic, Pak Choi, Asparagus,

### Where's My Plot?

A number of Allotment Tenants have asked how the “Allotment Map” was produced. Originally the layout of plots was simply a numbered table but over time and with the increase in the number of half plots it became difficult to be able to see where one plot ended and another started and it was realised that something better was needed. A decision was made to utilise a drone to photograph the overall site and the map opposite was derived from this. It will be noted that plots 7 and 8 and 22 and 23 are not shown as these are not let. The reason for this is not clear but it is assumed that , historically, it was felt that the hedging which acts a barrier between the allotments and the Sports Field would take too much moisture from the soil and would be invasive. Part of plot 22 is used to store waste from the allotments although it has become apparent that some “fly tipping” has been occurring and domestic garden waste has been dumped in the space.

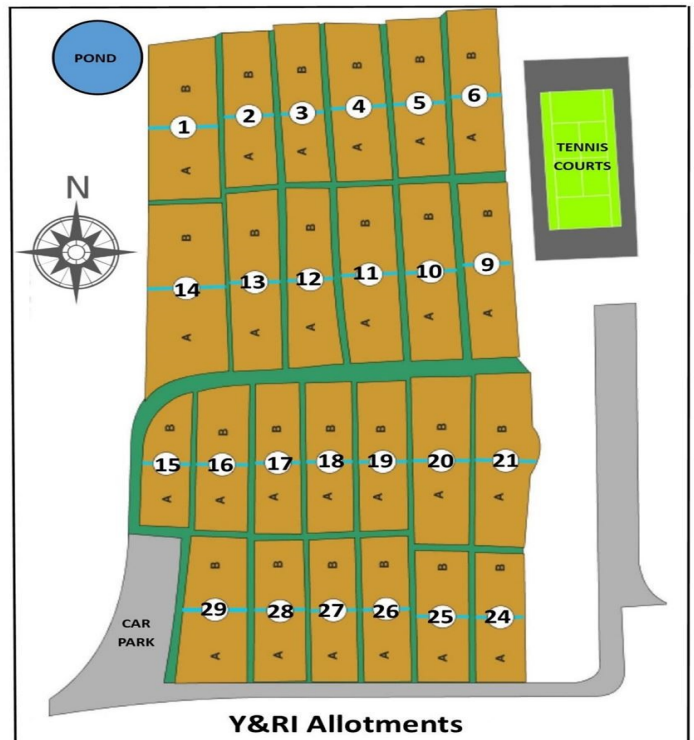

# THE ALLOTMENT

## Notes from the Parish Council

Many thanks to all those Allotment Tenants who have paid their annual rent. It is helpful if payments are made in April at the start of the Council year as per the contract conditions as it saves the need to send out reminders. Several plots are vacant and we are in the throes of offering these to residents on our waiting list. Some of these plots are particularly overgrown and consideration is being given to strimming back some of the more rampant vegetation that is present. The Fair Association have asked us to thank all the users for your co-operation in allowing the central allotment path to be used for access to the Sports Field where the fair was held. We are aware that damage by free ranging deer is becoming more of a problem and we are seeking quotations for the provision of fencing. The fencing installation will potentially be split into 4 phases in order to spread the cost the first phase being to secure the northside of the site. This may not be easy as the land beyond the designated allotments has various uses which makes installation complex. Once we have an idea of prices and the advice of the contractors we will discuss the options with the nominated Allotment Representatives and with those Allotment Tenants likely to be affected before making any final decisions which will obviously be dependent on funds being available. Another issue that we are looking at, and this is made more urgent due to the evidence of fly tipping, is the need to have a more satisfactory way of dealing with waste from the allotments. The Dorset Waste Partnership have been approached but can only offer the 240L bins that are used for the domestic garden waste removal when it is felt that a lockable wheeled 1000L bin would be more appropriate. We are continuing to explore how we can provide this and where such a bin could be located particularly as the space needed for access for exchanging bins is somewhat limited.

YRIPC Hamcrate Management Group

### Resurfacing of the Allotment Car Park

The Community Infrastructure Levy (CIL) that was made available following the Upbury Grange Development has meant that we are able to set aside funds to resurface the allotment car park and we have approached Dorset Highways for an estimate of the cost (they previously resurfaced the car park to the Jubilee Hall). Assuming we are able to proceed with this we will need to ensure that all Allotment Tenants are informed of the dates for the work. We are also aware that several vehicles are parked in the car park overnight and we are looking at how we can deal with this within the constraints of the King conditions for the use of the land.

David Torrance (CIL Lead)

### Allotment Self Help Group



We are aware that several of our allotment tenants are finding the chores of allotment ownership difficult. Additionally an illness or necessary absence can mean a lot more work on returning. An idea would be to have an SOS team of user volunteers who would take on any maintenance that needs doing in the users absence. This is something we want to discuss with the Allotment Representatives so watch this space!

YRIPC Hamcrate Management Group

# THE ALLOTMENT

## Supplementary

The following update, although intended for those Allotment Tenants who attended the initial meeting, is included with the news letter to ensure that all those who use the Hamcrate Allotments are aware of the discussions being undertaken between the Parish Council and the nominated Allotment Representatives.

Please note that the reference to Parish Council Allotment Working Group should read YRIPC Hamcrate Management Group and the National Allotment Society refers to the National Society of Allotment and Leisure Gardeners

Editor

*Hi fellow allotmenters, our summer is now becoming a distant memory, and winter is upon us, but as our work slows down for the winter on our allotments, work is continuing behind the scenes by the Hamcrate6 and our Parish Council. As you know, to date we have produced the Statement of Agreement, our co-working document between the allotment tenants and our Parish Council. We are currently working on the drafts of two other documents, a Mission Statement, and a Constitution, should we decide to form an Allotment Association.*

*To that end and more importantly for now we have been able to invite two representatives from the National Allotment Society, as our Parish Council are members of the National Allotments Society, to meet with the Parish Council Allotment Working Group and the Hamcrate6 in November. The purpose of the meeting is to gain an understanding of the type of association we might form, the benefits, drawbacks, advantages, disadvantages, obligations (legal and others), of forming an Allotment Association. We are working on an agenda for the meeting to ensure we gain the maximum knowledge in the time allotted, to allow further discussion between our Parish Council, the Hamcrate6, allotment users, and the wider community, so that final decisions can hopefully be made in February/March.*

*If you have any questions or comments, please do email me with them - [roddinnage@gmail.com](mailto:roddinnage@gmail.com).*

### **Editorial Statement**

The Newsletter and the supplementary attachments are intended to provide information on the Hamcrate Allotments as part of the interchange between the Council, its tenants and the wider community. It should be recognised that it is a "first attempt" and treated as such. Any mistakes or inaccuracies are the responsibility of the Editor alone.

### **Disclaimer**

This newsletter is produced in good faith and the Yetminster & Ryme Intrinsic Parish Council accepts no responsibility for any inaccuracies or for any action by any person or their agents or employees as a result of these inaccuracies.

**Yetminster & Ryme Intrinseca Parish Council & the Hamcrate Allotment  
Tenants Representatives.**

**Joint Statement of Agreement**

1. It is recognised that that all allotment users should be kept informed and are aware of the discussions being undertaken between the nominated allotment representatives and the YRIPC and have the opportunity to be able to comment.
2. It is recognised that the YRIPC favour the formation of an Allotment Association to take on the day-to-day management of the allotments but that, for the time being, the interests of the allotment tenants will be represented by the 6 duly nominated Hamcrate Allotment Tenants Representatives.
3. It is recognised that the YRIPC is a member of the National Association of Allotment and Leisure Gardeners (NSALG) and that efforts will be made by the YRIPC, and clarification sought, as to the potential to filter down to the allotment users the various benefits that this membership brings.
4. It is recognised that the YRIPC seeks to provide transparency in all its financial activities and that there is specific benefit in providing clarification as to the allotment costs, income and expenditure and that the Costing Table contained within the 4<sup>th</sup> March 2020 YRIPC Allotment Report needs to be updated to consider increased costs etc.
5. It is recognised that the YRIPC feels, in the above report, that the fencing of the Hamcrate Allotments and the improved security this provides is desirable and that, with the increased deer intrusion into the site, the Hamcrate Allotment Tenants Representatives feel that this is now essential.
6. It is recognised that the YRIPC has a 10- year project within the Costing Table contained within the 4<sup>th</sup> March 2020 YRIPC Allotment Report to secure funding to provide the above fencing. Ideally the fencing should be installed as a complete project, but funding limitations may make it necessary to do this in phases in which case protection for deer intrusion must be a priority.
7. It is recognised that as a public body the YRIPC should seek to make every endeavour to draw down on external funding where this is available in order to relieve stress on the overall precepted parish budget.
8. It is recognised that under the terms of 7 above the YRIPC has proposed to reinstate the unused plots nos 22 A&B and 23 A&B and identify these plots to be initially offered to Upbury Grange residents so as to meet the criteria for CIL funding.
9. It is recognised, and that as part of the proposal in 8 above, the YRIPC wishes to remove the existing hedge between plots 22 A&B and 23 A&B and the Sports Field Car Park as part of the reinstatement work and to replace this with fencing. This would run between the north and east allotment gates and would be included as part of the re use of these two plots using CIL funding.

10. It is recognised that the Hamcrate Allotment Tenants Representatives are against the removal of the aforementioned hedge and that therefore the reinstatement of plots 22 A&B and 23 A&B is unlikely to take place and that CIL funding will not be available for either this work or for the fencing in this area as described as the required criteria cannot be met.
11. It is recognised that, although it has reservations as to the arguments used for the retention of the hedge, the YRIPC will not proceed with the proposal to remove the hedge as described above and that there are financial ramifications to this decision.

It is further recognised that, as the hedge is to be retained, there is the potential, when trimming it, to lower its height which will help offset security issues relating to the Sports Club.

12. It is recognised that the Hamcrate Allotment Tenants Representatives wish for the provision of additional water supply points and that this will require further discussion and agreement with the YRIPC. It is noted that a 5-year funding initiative for additional water supply points is identified within the Costing Table contained within the 4<sup>th</sup> March 2020 YRIPC Allotment Report.
13. It is recognised that any works, when agreed, must be practical, represent value for money and comply with the relevant legislation and good practice and that funding must be in place.
14. It is recognised that the Allotments are available to all residents within the Parish Area of Yetminster & Ryme Intrinsic as per the original King Family gift of the land.
15. It is recognised that the Hamcrate Allotment Tenants Representatives are aware that the allotment users themselves undertake certain maintenance functions, as identified within the Costing Table contained within the 4<sup>th</sup> March 2020 YRIPC Allotment Report, and that this will require further discussion and resolution with the YRIPC.
16. It is recognised that the YRIPC feels, in the above report, that the provision of dedicated compost and waste facilities is desirable and that the Hamcrate Allotment Tenants Representatives feel that this is essential.
17. It is recognised that a good working relationship between the YRIPC, the Hamcrate Allotment Tenants Representatives and all allotment users is essential and that one or more meetings are to be arranged to work through any outstanding issues identified within this Joint Statement of Agreement and that all issues are to be resolved or an acceptable compromise reached, amicably and with the mutual respect of all the parties involved.
18. It is recognised that, notwithstanding the proposed meeting in 17 above, there is a benefit to regular meetings between the YRIPC, the Hamcrate Allotment Tenants Representatives and the allotment users and that agreement for these should be sought.

This Statement of Agreement is produced in the spirit of co-operation, and it is hoped that it will provide a basis for the way forward in the relationship between the YRIPC and its allotment tenants.

*These statements are drawn from the minutes of the 5<sup>th</sup> July 2023 meeting of the Hamcrate Allotment Tenants, the response to these by the YRIPC and to the YRIPC 4<sup>th</sup> March 2020 YRIPC Allotment Report and the subsequent summary of this, and survey of allotment users sent in May 2022 and to the letter accompanying the issuing of new allotment agreement sent on the 18<sup>th</sup> September 2022*